

1. Go to **Settings**

2. Press **Add account**

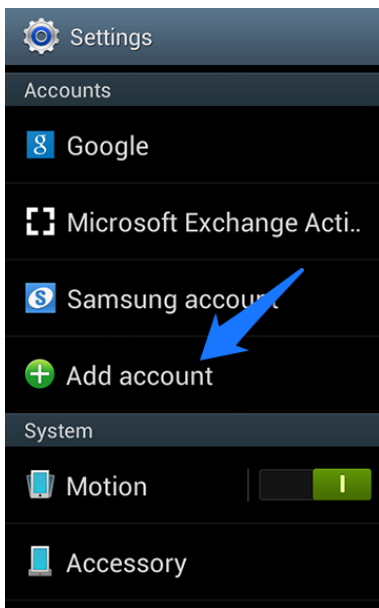

3. Press **Email**

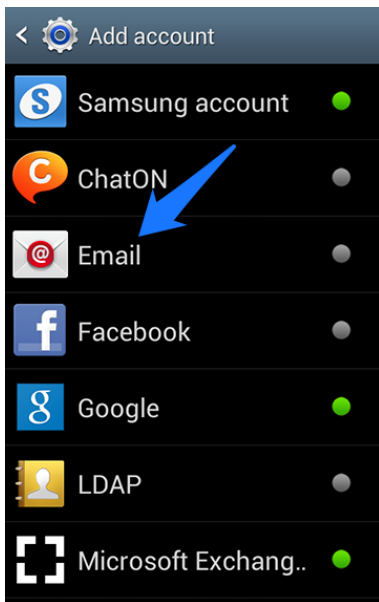

4. Now you'll be asked to configure the basic settings

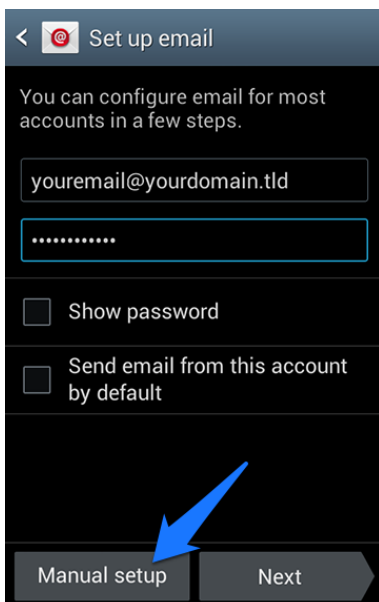

1. Enter youremail@yourdomain.tld
2. Enter the password to your e-mail account

Press **Manual setup**

5. Choose **IMAP account** when asked

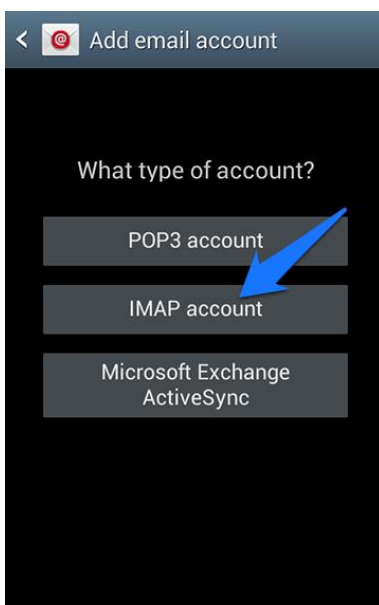

6. Now you'll be asked to configure the incoming server settings

1. **User name:** Enter youremail@yourdomain.tld
2. **Password:** Enter the password to your e-mail account
3. **IMAP-server:** Enter mail.yourdomain.tld
4. **Security type:** Choose None
5. **Port:** Enter 143
6. **IMAP path prefix:** Enter INBOX

Press **Next**

7. Now you'll be asked to configure the outgoing server settings

1. **SMTP server:** Enter mail.yourdomain.tld
2. **Security type:** Choose None
3. **Port:** Enter 587
4. **Require sign-in:** Checked
5. **User name** Enter youremail@yourdomain.tld
6. **Password** Enter the password to your e-mail account

Press **Next**

Press **Done**